

YOUR EMU-2™ INFORMATION LABEL

V2.1



EMU-2™
Energy Monitoring Unit

Located on the back of your **EMU-2™** is the Information Label that identifies your individual device. You will need the two numbers indicated below to register your device. Please make a note of them:

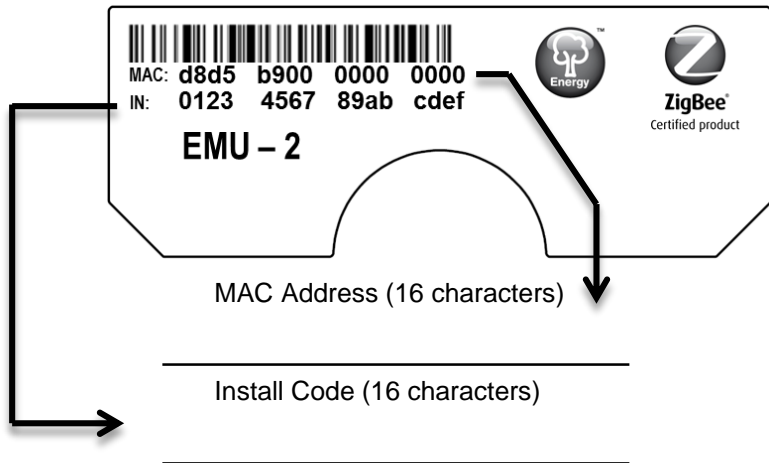

Quick Start GUIDE



A new way to see your energy

TROUBLESHOOTING TIPS

Blank screen - unit does not respond to button press	<ul style="list-style-type: none"> • Unplug power & remove batteries. • Wait 10 seconds. • Re-connect power; this will reset the unit.
Unit has power but does not display data	<ul style="list-style-type: none"> • Check display for signal strength. If weak signal, move unit closer to the meter for a stronger signal. • Move unit away from electronic devices that may interfere with the signal (eg. wireless routers, cordless phones).
Display only says, "Searching for meters"	<ul style="list-style-type: none"> • Contact your utility to provision your meter.

WHAT'S IN THE BOX:

- **EMU-2™** ENERGY DISPLAY
- AC POWER ADAPTER
- AAA BATTERIES (2)

NEED HELP WITH YOUR EMU-2™?

For a full user manual, FAQs, and to contact support:
rainforestautomation.com/emu2_support

START VIEWING YOUR REAL-TIME ENERGY INFORMATION IN FOUR EASY STEPS:

STEP 1: REGISTER WITH YOUR UTILITY

You will need to provide your MAC Address and Install Code from the Information Label on the back of your **EMU-2™**. It may take some time for your utility to enable your meter to connect to your device. It is important to wait until this is complete before proceeding to the next step.

STEP 2: PLUG IN YOUR EMU-2™

Plug the AC Adapter into a power outlet, and plug the other end of the cord into your **EMU-2™**.

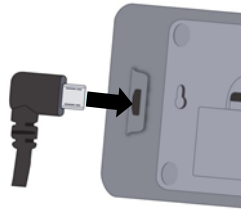

Batteries may also be used as a source of short-term alternative power, but the **batteries are not intended to be the primary source of power**, and may only last a few days of continuous use. If using battery power, ensure that only alkaline batteries are used. Note that batteries do not recharge when the unit is plugged in. Also note that putting a battery in backwards can be hazardous, and may cause extensive damage to your **EMU-2™**.

STEP 3: WAIT FOR EMU-2™ TO JOIN THE METER

Once powered up, the unit will attempt to connect to the meter. You will initially see dashes on the screen. The **EMU-2™** is ready to use once the Current Time screen appears with the time and date displayed

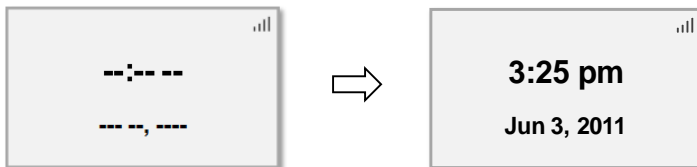

STEP 4: CONFIGURE YOUR EMU-2™

- Press both of the buttons simultaneously and release.
 - Press the Bottom Button to skip the Restart screen.
 - Press the Top Button to select the language you would like to use; press the Bottom Button to save your selection.
 - Set your electricity price. The digit to be modified will be flashing, starting on the right, and working left. After you have entered all 5 digits of the energy price, you will see the Time Options screen.
 - You may need to set the time zone (ask your utility). When done, press the Bottom Button to go to the Power Source screen.
 - Press any button to return to the Current Time screen.
- Your **EMU-2™** is ready to use.

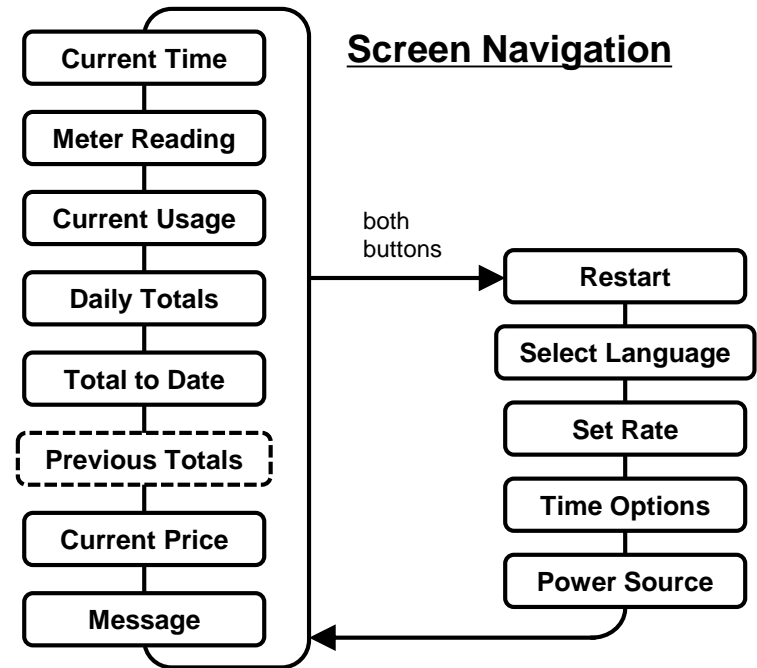

SEE THE FULL **EMU-2™** USER GUIDE ON OUR WEBSITE:
rainforestautomation.com/emu2_support